

### **How You're UltraPure™ Automatic Water Cleaner™ Works**

The *UltraPure™ Automatic Water Cleaner™* produces the strongest Oxidizer (Ozone) commercially available for pool (and spa) water treatment. *UltraPure™ Automatic Water Cleaners™* take over the oxidation work usually done by chlorine (or bromine). Incomplete oxidation by chlorine, accounts for up to 70% of its usage and 100% of its problems. With an *UltraPure™ Automatic Water Cleaner™* installed, Ozone removes compounds that normally combine with chlorine. Obnoxious combined chlorine compounds (chloramines and scum lines) are not formed. Once this oxidation is accomplished, smaller amounts of chlorine provide a 'free - available' residual that is a very effective biocide to kill viruses, bacteria and algae. This produces superb water quality and minimizes chemical usage. **Using *UltraPure™ Automatic Water Cleaners™* result in the least amount of chemicals of any method currently available for pool (and spa) water treatment.**

### **Keep UltraPure Running For:**

- \$ A nature fresh bottled-water swimming experience
- \$ Cost savings, fewer chemicals & less maintenance
- \$ Extended life of pool equipment & longer filter runs

### **When UltraPure is Working:**

- \$ There's a blue light & a champagne mist from the return(s)
- \$ Combined chlorine readings are never above 0.5 ppm
- \$ Chlorine associated problems are eliminated

## **Parts, Options, Accessories & Requirements**

#### **Each unit comes with:**

- ✓ (1) 1/2" Conduit or cord compression fitting
- ✓ (1) 6 feet of 14 gauge wires (240V)  
**Or**
- ✓ (1) 6 feet of 18 gauge wires (120V)  
**Or**
- ✓ (1) 8 Foot Nema Cord Set (Also Available)
- ✓ (1) Ground Lug for #6 bonding wire
- ✓ (1) Valve-Less Suction Side Parts Package



Compression fitting & Ground Lug

#### **To Install you will need:**

- (1) Flowmeter Kit (0-10 or 0-50)
- (1) Length of 1/2" conduit for connection to power supply
- (1) 1/2" Conduit compression fitting for power supply connection

#### **Each Valve-Less Suction Side Parts Package (VSSPP) comes with:**

- ✓ (1) 1/4" NPT x 3/8" Kynar 'glow' compression fitting elbow
- ✓ (1) 2" by 1/4" Air Flow Control Insert™ (AFCI™)
- ✓ (2) # 8 x 1" Mounting screws and wall plugs
- ✓ (1) 15 Foot length of 3/8" black tubing
- ✓ (1) Warranty card and owner's manual
- ✓ (1) 1 1/2 lb. 1/4" MPT x 3/8" Tubing compression fitting check valve - Retrofit Only
- ✓ (1) 1/4" NPT x 3/8" Compression fitting - Builder Only
- ✓ (1) 3/4" FSL x 1/4" FPT Reducing coupler - Builder Only



Part No. 1008072

#### **An Optional External (Safety) Air Bleed Kit (ESABK) is available & includes:**

- (1) 1/4" Brass Street Tee
- (1) 1/4" NPT x 3/8" tubing compression fitting
- (1) 15 Foot length of 3/8" O.D. black tubing
- (1) 1 1/2" - 2" Saddle clamp and gasket c/w with 3/8" tubing compression fitting



Part No. 1008028

## **General Information**

The two methods of installing your *UltraPure™ Automatic Water Cleaner™* are very simple. A compression fitting or compression fitting check valve is installed on the suction side of the pump. With the pool pump running and our exclusive Airflow Control Insert™ (AFCI™) in place, Ozone and air is drawn into the pump. This Ozone (air mix) goes through the pump impeller and the Ozone is pressurized into the water, and enters the filter. The internal (and/or external) bleed tube sends air out to the pool as a fine bubble mist. As much as 70 - 95% of the Ozone is absorbed by the water before it reaches the filter and the remainder is absorbed in the return lines on the way back to the pool. When the pump shuts off, our 1 1/2 lb. compression fitting check valve **or** the builder - installed below grade tee and the 3/4" stand pipe, prevents air from leaking back into the system and potentially causing the loss of pump prime.

Each *UltraPure™ Automatic Water Cleaner™* has a standard Valve-Less Suction Side Parts Package. If you wish to utilize an alternate injection device, it must be purchased separately. Our Model Number indicates unit capacity at 6 - 12 hours of operation per day. All UPP units have United States Gallon & Pump Size recommendations listed in the chart on page 4. Upsize or downsize the units according to the daily pump run time and **upsized** when there is a pool - spa combination.

To successfully install our suction side units, you must consider the following points:

- a) Use a Start - Up Flowmeter Kit to set airflow rates. (UWQ Part No. 1008037 or 1008038)
- b) An air draw above the maximum will lower the effectiveness.
- c) Smaller sized pools may require an airflow rate in the lower end of the typical airflow;  
e.g. A UPP15 on a 12,000 USG pool can use 3 - 7 cfh;  
A UPP50 on a 50,000 USG pool can use 4 - 14 cfh
- d) Increase run time when bather loads are very heavy and when weather conditions are severe.

## **Suction Side Installation**

### **A) Site Selection**

1. Select a wall location, within five (5) feet of the 120V or 240V 'timer' box or the 120V grounded plug; within eight (8) feet of the suction side injection point, and in easy sight of the Kynar compression fitting 'glow' elbow. **Ensure the location conforms to local electrical codes.**
2. a) Your **240V UltraPure™ Pool Automatic Water Cleaner™** comes with a 1/2" conduit compression fitting with 5 feet of 14-gauge wire to connect to the 'load side' of the timer. This requires a field supplied 1/2" flexible conduit and a second 1/2" conduit compression fitting. Power requirement is 240V/60Hz 1.0 - 2.0 Amps.  
**OR**  
b) Your **120V UltraPure™ Pool Automatic Water Cleaner™** comes with an eight (8) foot cord set or 5 feet of 18 gauge wires. Your 120V can be connected to the 'load side' of the timer or it can be plugged directly into a grounded receptacle. Power requirement is 120V 1.0 - 2.0 Amps.
3. Ensure the unit is grounded (using the ground lug on the unit and a field supplied bonding wire) in accordance with local electrical codes. **A qualified electrician should perform the electrical procedure(s).**
4. This electrical 'hook - up' ties the *UltraPure™ Automatic Water Cleaner™* into the pump power supply. When the pump is on, the ozone generator is on. Operating your *UltraPure™ Automatic Water Cleaner™* on a single speed pump 6 - 12 hours per day will clean the pool water and bulb life is extended. When using a two-speed pump the Ozone Generator is operating only on high speed, typically 2 - 4 hours per day. Your *UltraPure™ Automatic Water Cleaner™* should be mounted horizontally to improve lamp life. Use the holes in the mounting tabs, the screws and wall plugs provided to secure the unit.



Site Selection

### **5. Installation Steps**

1. **Shut off the pump** and use the Valve-Less Suction Side Parts Package (VSSPP Part No. 1008072).
2. a) For **A Builder Standpipe Installation – (Into A Pre-Installed 3/4" pipe)**: When the pool is being built, or during renovation work, it can be made *Automatic Water Cleaner™* (Ozone) ready. 'Tee in' a 3/4" stand pipe from (one of) the suction line(s) **below water level** and run it to a protected location behind the filter on the equipment pad. Cap the standpipe for pressure testing the plumbing. When you are ready to install the *UltraPure™ Automatic Water Cleaner™*, cut the cap from the 3/4" stand pipe and glue on our 3/4" FSL x 1/4" FPT reducing coupling. Apply Teflon tape and screw in the 1/4" NPT x 3/8" straight compression fitting into the reducing coupling. The 1-1/4b compression fitting check valve is not required (See Drawing No. I).

**OR**

- b) For **A Retrofit Installation - Into The Strainer Basket (Hair & Lint Trap) Drain Plug**: Apply Teflon tape and screw the 1 1/4b NPT x 3/8" compression fitting check valve into the bottom drain plug hole in the hair & lint (strainer) basket of the pump. The straight compression fitting & reducing coupling are not required (See Drawing No. II).



Retrofit into the Strainer Basket

3. **An External (Safety) Air Bleed Kit for Inground units is advisable.** Install the External (Safety) Air Bleed Kit (ESABK) as per the attached drawings (Drawings I and II). This kit is designed to take air from the top of the filter and send it down stream (up to 15 feet) past any and all equipment. The brass tee (supplied) screws into the pressure gauge port as per the diagram. In some cases, it is necessary to install this tee into the manual air relief port or opening. Be sure all air is venting from the filter as the pump runs. The internal bleed in the filter acts as a backup to the external kit. Installation of the ESABK is **necessary** when, the filter is old and does not have an internal air bleed; there is a solar system on the pool; or, there is a pressure side cleaner or with a booster pump.



Part No. 1008028

4. Thread the 1/4" NPT x 3/8" **Kynar compression fitting 'glow' elbow** into the 1/4" threaded hole opposite the cord end of the unit.
5. **With the power off**, wire your 120V or 240V *UltraPure™ Automatic Water Cleaner™* into the load side of the timer (with the pump) or plug your 120V unit into a grounded receptacle. Be sure to check the voltage of your power supply matches the voltage of your unit. **A qualified electrician should perform the electrical procedure(s).**

Cont...

6. a) **For Builder Installation** - Connect the black 3/8" tubing to the compression fitting in the top of the standpipe reducing bushing. Cut the tubing to a length that 'comfortably' reaches the unit. With this installation a suction side stand pipe runs from below water level on a suction line, back to a convenient location (behind the filter) on the equipment pad. This will stop air from entering the pump. Since the 3/4" line originates from below water level (below grade) there is no possibility to lose prime because there is a water lock below grade.
- OR**
- b) **For Retrofit Installation** - Connect the black 3/8" tubing to the compression fitting check valve at the pump basket. **With the pump off prevent loss of prime with the Retrofit Method...** The possibility exists that air can enter the pump and water lines through the *Automatic Water Cleaner*. Ensure that the 1 1/2 lb. check valve is not allowing air to bubble back into the pump basket when the pump is turned off. If the check valve allows air to bubble back into the pump basket, call the manufacturer – 877 281-7603.
7. To control the airflow through the unit, insert the 1/4" Air Flow Control Insert™ (AFCI™) half way in the (unit) end of the 3/8" tubing. Turn the power **ON**; **START** the pump; and, **CHECK** that the 'glow' Kynar compression elbow lights up a blue/green colour. With pump running, adjust the air draw to suit the pump size while ensuring it does not exceed the maximum for the unit size. The airflow is adjusted by moving the *Air Flow Control Insert™ (AFCI™)* in for less airflow and out for more airflow. Once the desired airflow is attained, cut the excess *Air Flow Control Insert™ (AFCI™)* off and discard it. Push the remaining portion of the *Air Flow Control Insert™ (AFCI™)*, 2" - 3", into the tubing. Connect the 3/8" tubing with the *Air Flow Control Insert™ (AFCI™)* inside, to the compression-fitting elbow in the *UltraPure™ Automatic Water Cleaner™*. Your installation is complete. With the pump running, your *UltraPure™ Automatic Water Cleaner™* is introducing the strongest *Oxidizer* commercially available into the pool water.



Insert AFCI™ in 3/8" Black Tubing



Set Optimal Airflow



Cut Excess AFCI™ & push 2" - 3" Inside Tube



Insert Tubing in Glow Fitting Elbow & Start Pump

**Pump Size & Air Draw Chart**

Model	USG	Pump Size (Minimum)	Airflow Rate (Cubic Feet Per Hour - cfh)	
			TYPICAL	Recommended
UPP15	15,000	1.0 HP	3 - 7	5
UPP25	25,000	1.5 HP	4 - 10	7
UPP50	50,000	2.0 HP	4 - 14	10

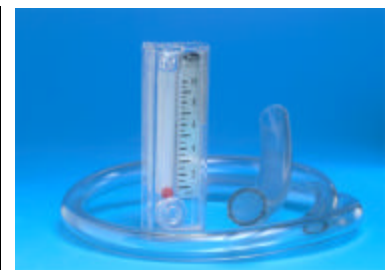

Part No. 1008037

Ensure a 'fine bubble mist' is entering the pool through one or more returns. Shut the pump off and ensure that most of the air is leaving the filter, i.e. there is no surge or back up of air through the suction (skimmer or drain) lines.

**OWNER'S MANUAL INCLUDING  
VALVE-LESS SUCTION SIDE  
INSTALLATION**

**UltraPure™**  
Turbo Shock • Ozone Generators  
**Automatic Water Cleaners™**  
**For Inground Pools**

**VALVE-LESS  
BUILDER STANDPIPE  
&  
RETROFIT METHODS**

1.	Builder Installed 3/4" Standpipe (connected below water) with supplied reducing coupling and compression fitting
2.	3/8" Black Poly Tubing (15 Feet) From suction-side compression fitting to the UltraPure™ Automatic Water Cleaner™
3.	1/4" NPT x 3/8" Tubing Kynar 'glow' Elbow Compression Fitting
4.	Detail of (1/4" Threaded) Air Flow Control Insert™ (AFCI™) Inside The 3/8" Black Tubing
5.	UltraPure™ Automatic Water Cleaner™
6.	Power connection for 240V or 120V Three Conduit Wires (5 Feet) - Hardwired to the load side of timer with the pump or another 240V power supply; For 120V. The 3 Prong Nema power cord (8 feet) is connected to a power supply tied into the pump.
7.	Grounding Lug - Connect to known ground with field-supplied copper bonding wire.
8.	<b>OPTIONAL</b> External (Safety) Air-Bleed Kit Includes: 1/4" Brass Street Tee, 1/4" NPT x 3/8" Compression Fitting, Black 3/8" Poly Tubing (15 feet) and 3/8" Compression Fitting, Saddle Clamp and Gasket.

Drawing I – BUILDER STANDPIPE INSTALLATION

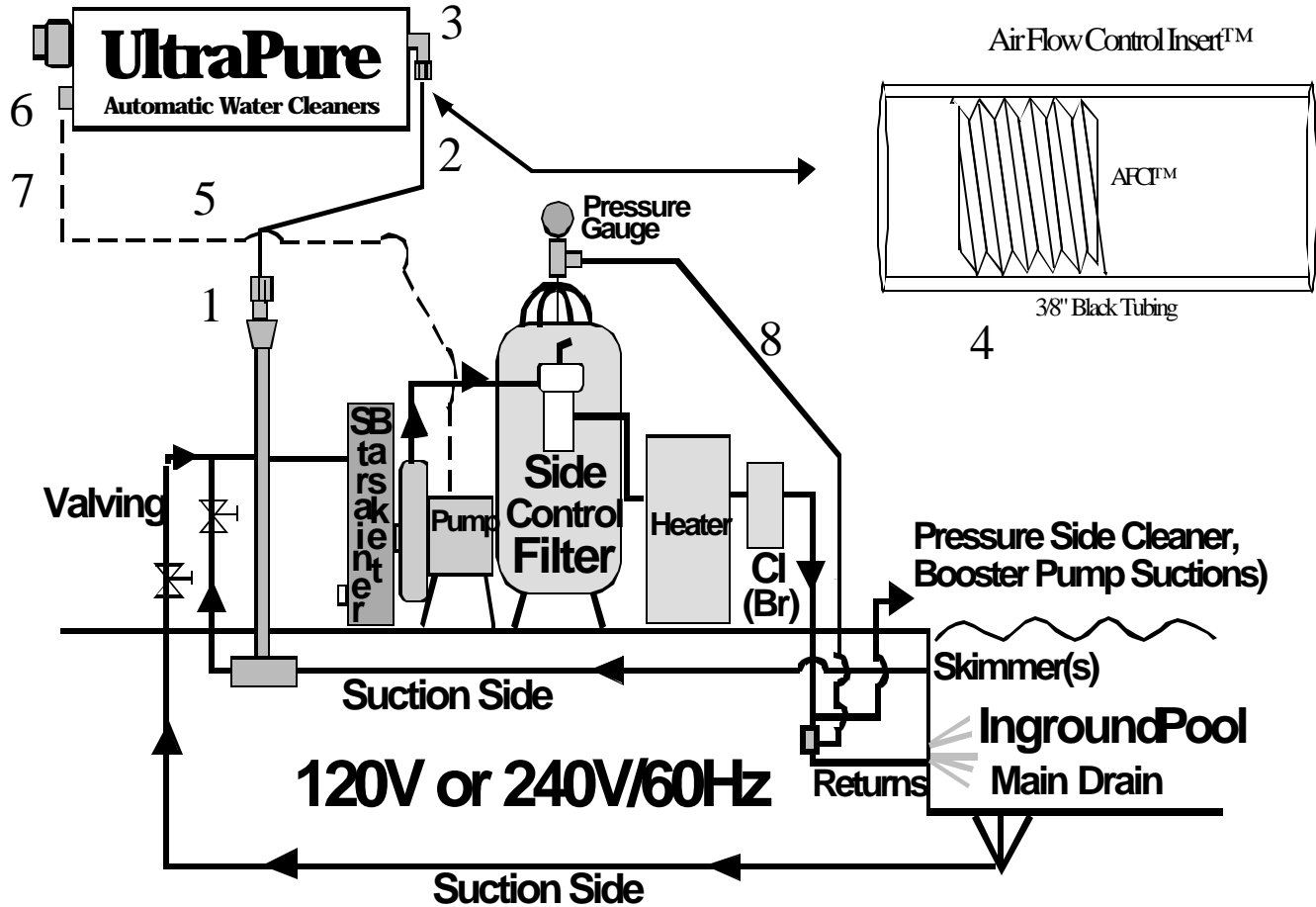

**OWNER'S MANUAL INCLUDING  
VALVE-LESS SUCTION SIDE  
INSTALLATION**



**VALVE-LESS  
BUILDER STANDPIPE  
&  
RETROFIT METHODS**

1.	Suction Side, 1/4" NPT x 3/8" Tubing Compression Fitting, 1 1/2" check valve in the strainer basket 1/4" NPT Drain Plug Hole
2.	3/8" Black Poly Tubing (15 Feet) From suction-side compression fitting check valve to the UltraPure™ Automatic Water Cleaner™
3.	1/4" NPT x 3/8" Tubing Kynar 'glow' Elbow Compression Fitting
4.	Detail of (1/4" Threaded) Air Flow Control Insert™ (AFCI™) Inside The 3/8" Black Tubing
5.	UltraPure™ Automatic Water Cleaner™
6.	Power connection for 240V or 120V Three Conduit Wires (5 Feet) - Hardwired to the load side of timer with the pump. For 120V the 3 Prong Nema power cord (8 feet) is connected to a power supply tied into the pump.
7.	Grounding Lug - Connect to known ground with field-supplied copper bonding wire.
8.	<b>OPTIONAL</b> External (Safety) Air-Bleed Kit Includes: 1/4" Brass Street Tee, 1/4" NPT x 3/8" Compression Fitting, Black 3/8" Poly Tubing (15 feet) and 3/8" Compression Fitting, Saddle Clamp and Gasket.

Drawing II – RETROFIT INSTALLATION

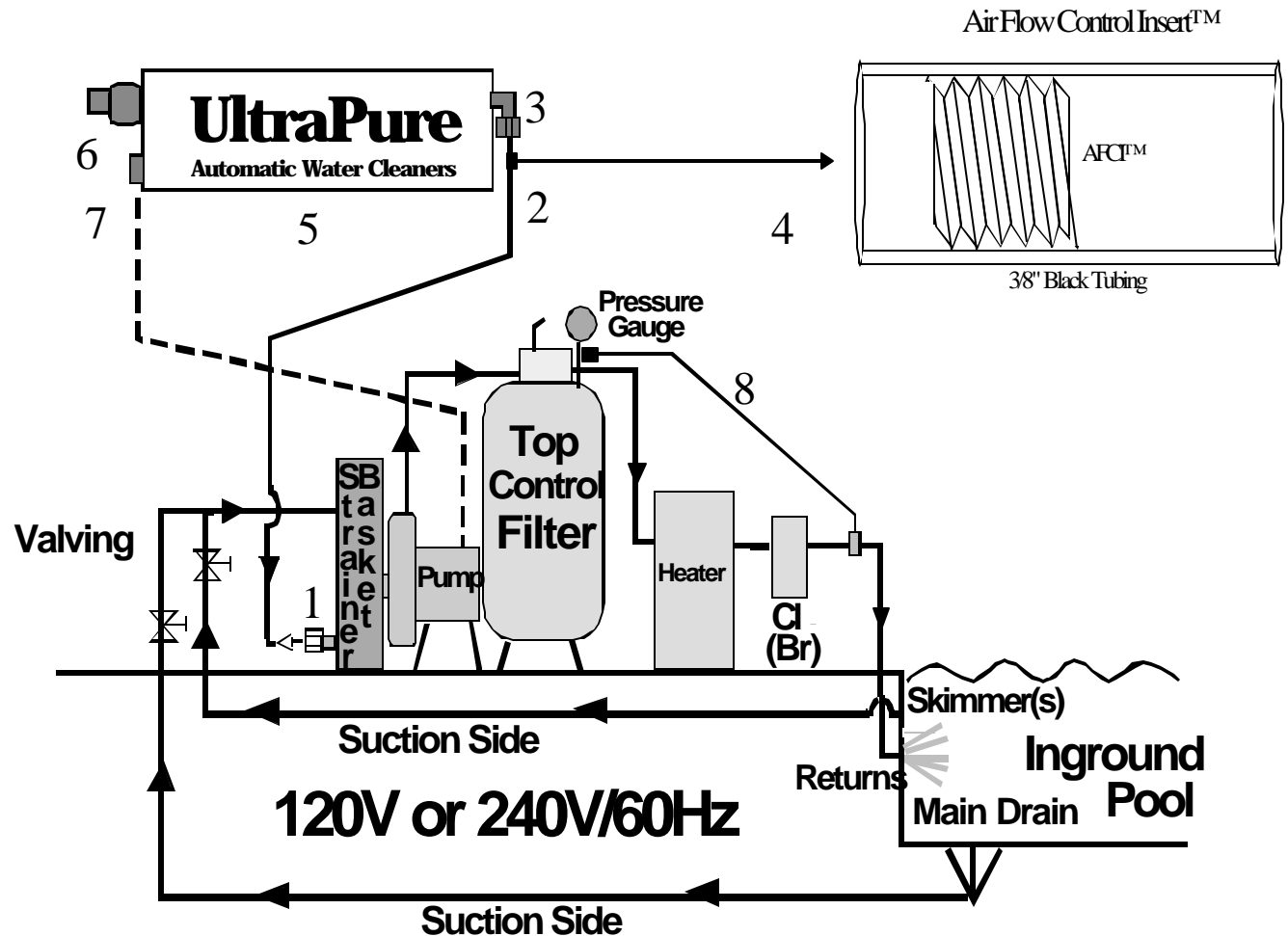

**OWNER'S MANUAL INCLUDING  
VALVE-LESS SUCTION SIDE  
INSTALLATION**



**VALVE-LESS  
BUILDER STANDPIPE  
&  
RETROFIT METHODS**

Part	Volt	Model UPP15	
1	120	3505061	Conduit Connector
	240	3505050	Conduit Connector
2	120	3403620	1/4" NPT x 3/8" T Kynar Elbow Fitting
	240		
3	120	3505890	External Ground Lug
	240		
4	120	3505225	1 – Transformer
	240	3505226	2 – Transformers
5	120	3505221	Glow Bottle Starter
	240		
6	120	3901823	Replacement UV Lamp
	240		
7	120	1008001	1/4" NPT x 3/8" T Compression Fitting 1 1/2" Check Valve
	240		
8	120	3403410	1/4" NPT x 3/8" T Compression Fitting
	240		
9	120	3406305	2" Air Flow Control Insert (AFCI™)
	240		
10	120	3407500	3/4" FSL x 1/4" NPT Reducing Coupling
	240		
11	120	3401117	15 Feet 3/8" Black Poly Tubing
	240		
12	120	3305911	1" #8 Installation Screws
	240		
13	120	3304500	Wall Plugs
	240		

**Pool Parts Diagram**

**Model UPP15  
120V/60Hz**

**Model UPP15  
240V/60Hz**

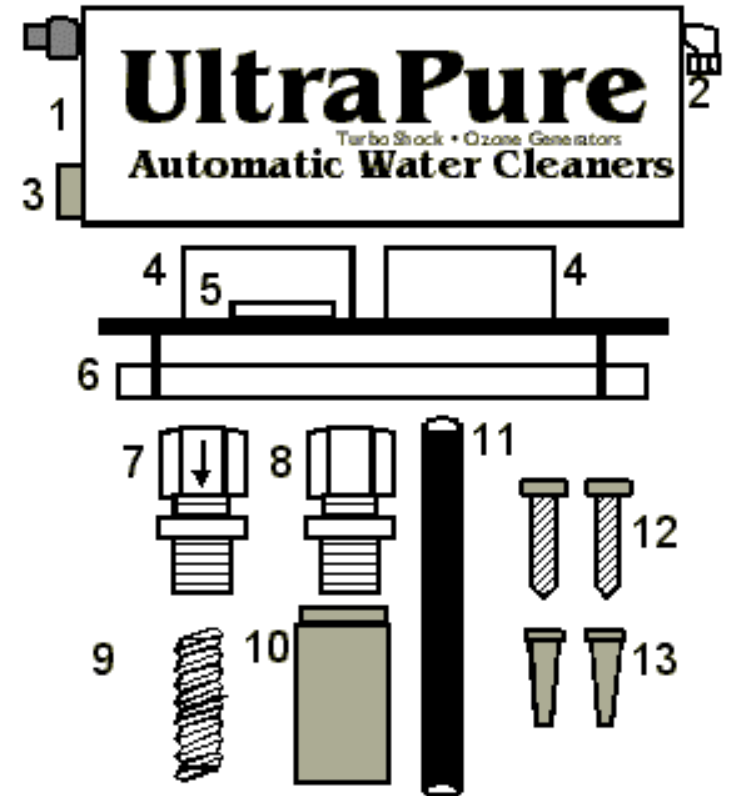
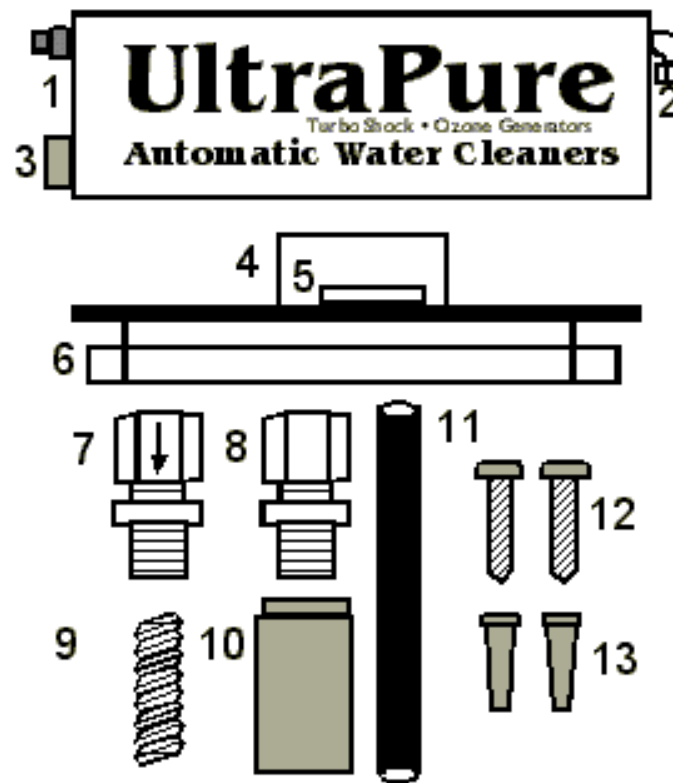

**OWNER'S MANUAL INCLUDING  
VALVE-LESS SUCTION SIDE  
INSTALLATION**



**VALVE-LESS  
BUILDER STANDPIPE  
&  
RETROFIT METHODS**

Part	Volt	Model UPP25	
1	120	3505061	Conduit Connector
	240	3505050	Conduit Connector
2	120	3403620	1/4" MPT x 3/8" T Kynar Elbow Fitting
	240		
3	120	3505890	External Ground Lug
	240		
4	120	3505225	2 – Transformers
	240	3505226	4 – Transformers
5	120	3505221	2 - Glow Bottle Starters
	240		
6	120	3901823	2 - Replacement UV Lamps
	240		
7	120	1008001	1/4" NPT x 3/8" T Compression Fitting 1 <del>1/2</del> Check Valve
	240		
8	120	3403410	1/4" NPT x 3/8" T Compression Fitting
	240		
9	120	3406305	2" Air Flow Control Insert (AFCI™)
	240		
10	120	3407500	3/4" FSL x 1/4" FPT Reducing Coupling
	240		
11	120	3401117	15 Feet 3/8" Black Poly Tubing
	240		
12	120	3305911	1" #8 Installation Screws
	240		
13	120	3304500	Wall Plugs
	240		

**Pool Parts Diagram**

**Model UPP25  
120V/60Hz**

**Model UPP25  
240V/60Hz**

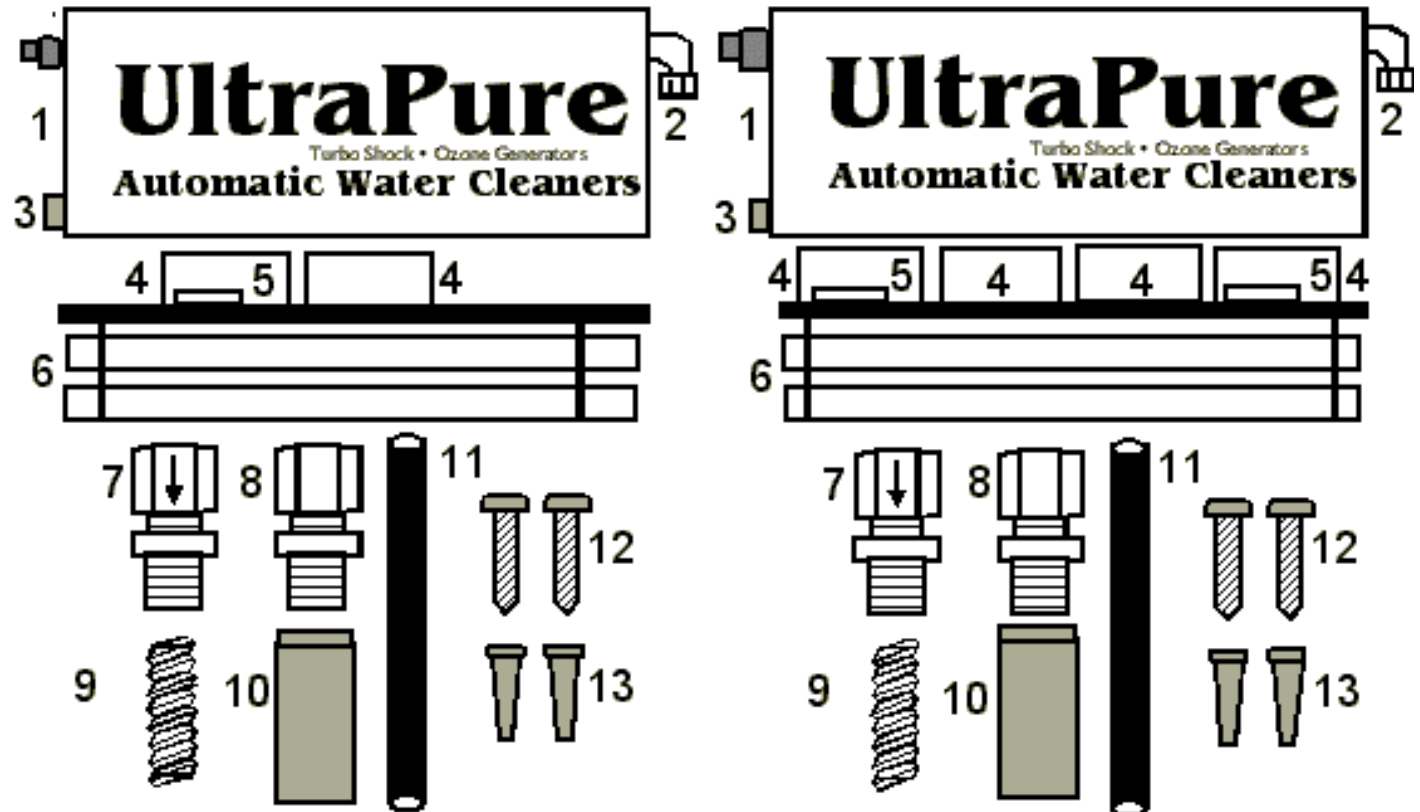



**OWNER'S MANUAL INCLUDING  
VALVE-LESS SUCTION SIDE  
INSTALLATION**



**VALVE-LESS  
BUILDER STANDPIPE  
&  
RETROFIT METHODS**

Part	Volt	Model UPP50	
1	120	3505061	Conduit Connector
	240	3505050	Conduit Connector
2	120	3403620	1/4" NPT x 3/8" T Kynar Elbow Fitting
	240		
3	120	3505890	External Ground Lug
	240		
4	120	3505200	Ballast
	240	3505180	Ballast
5	120	Not Required	
	240		
6	120	3901805	2 - Replacement UV Lamps
	240		
7	120	1008001	1/4" NPT x 3/8" T Compression Fitting 1 <del>lb</del> Check Valve
	240		
8	120	3403410	1/4" NPT x 3/8" T Compression Fitting
	240		
9	120	3406305	2" Air Flow Control Insert (AFCI™)
	240		
10	120	3407500	3/4" FSL x 1/4" NPT Reducing Coupling
	240		
11	120	3401117	15 Feet 3/8" Black Poly Tubing
	240		
12	120	3305911	1" #8 Installation Screws
	240		
13	120	3304500	Wall Plugs
	240		

**Pool Parts Diagram  
Model UPP50  
120V/60Hz and 240V/60Hz**

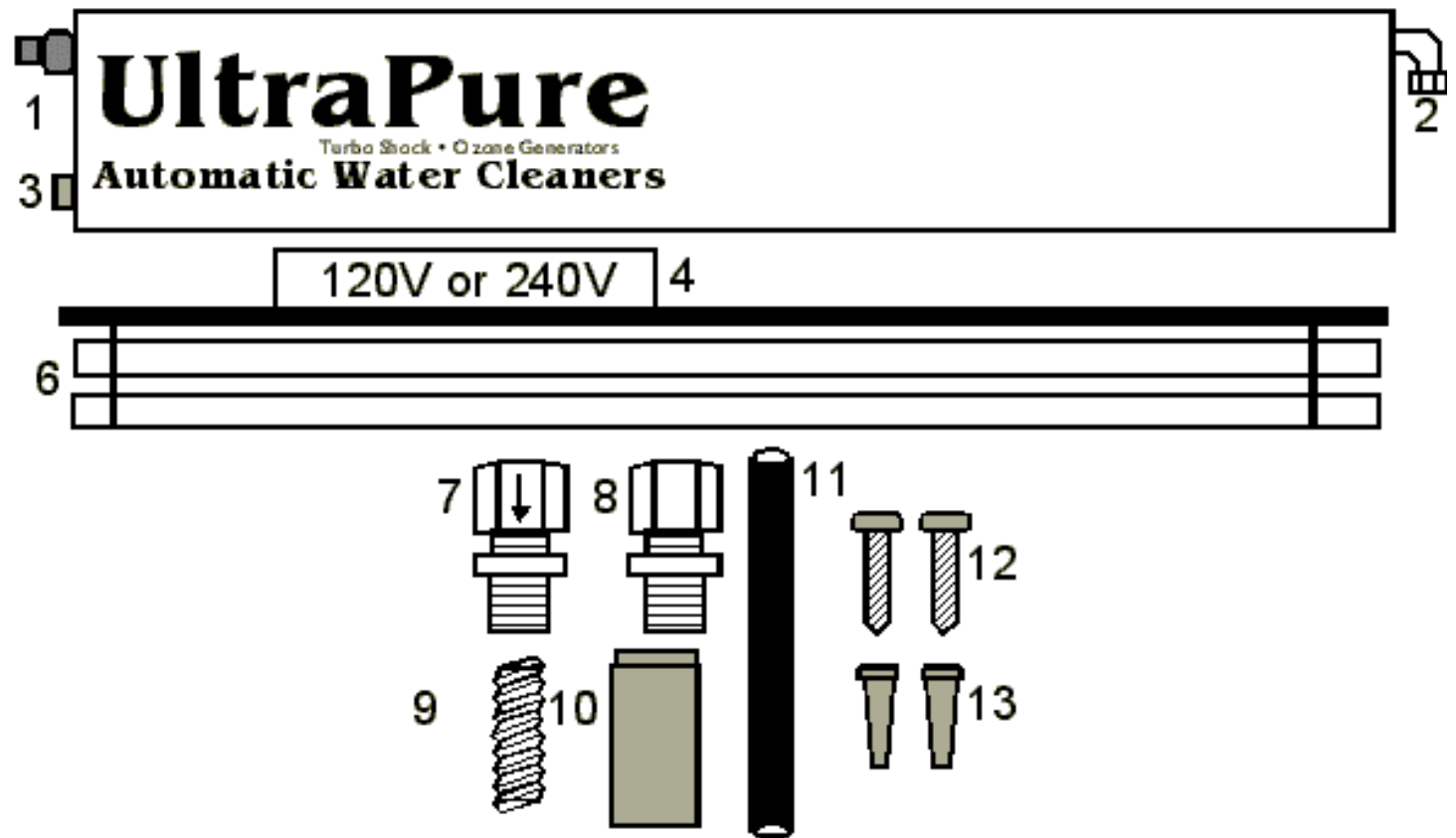

**For Inground Pools**

**Swimming Pool Operating Guidelines With Your UltraPure™ Automatic Water Cleaner™**

Test the water regularly using a water test kit available through your dealer or service company.

TEST	IDEAL RANGE
Bromine or	4.0 ppm
Free Chlorine (FAC)	2.0 ppm
Total Chlorine (T.C.)	Up To 0.5 ppm Above the FAC Reading
pH	7.4 -7.8
Total Alkalinity	100 - 130 ppm
Calcium Hardness	200 - 250 ppm
Total Dissolved Solids	300 - 1200 ppm

The free chlorine/bromine residual should be maintained at all times. Outdoor pools on chlorine require a stabilizer. Pools may require a shock treatment after very heavy usage, heavy rains or wind storms.

**Follow your dealer's recommendations.**



## A. Potential Air - Draw Problems

### 1. Pump Is Overly Noisy Or Looses Prime While Running

**NOTE:** A small amount of noise can be expected since air is being drawn into the pump and 'works its way' through the filter and pipes. Problems are solved by using one or more of the following alternatives; moving the injection point "up stream" from the pump; and/or reduce the airflow; and/or increase the water flow.

- \$ Plug the 3/8" tubing with the pump running and check for a suction side-plumbing leak.
- \$ Install the suction side injection point in the plumbing upstream before the pump.
- \$ Enlarge the eye - ball returns to maximize water flow and increase the pump's 'suction power'.
- \$ Decrease the air - draw (past our *Air Flow Control Insert™ (AFCI™)*) to the lower end of the recommended range.

### 2. Air 'Blow - Back' Through The Skimmer Line(s)

**NOTE:** An air build up in the filter causes this. When the pump shuts off, air expands and seeks 'the path of least resistance' to escape. This path is usually through the skimmer line. This problem is solved by completely removing air from the filter while the pump is running, or by stopping air from backing up through the suction (skimmer) lines.

- \$ Extend or install the internal air bleed line inside the filter. By ensuring this internal air-bleed line is as close to the top of the filter as possible, air readily escapes as the pump runs.
- \$ Where the External (Safety) Air Bleed Kit is installed, ensure it is actually releasing the air being introduced into the filter. The pressure gauge port or the manual air bleed port will work well on most filters. In some instances, the air bleed(s) inside the filter must be drilled out larger. To check that our External (Safety) Air Bleed Kit is letting air out of the filter - shut off the pump; disconnect the black tubing at the filter; hold your thumb over the tubing end (to close it off); start up the pump and see that air (and some water) is coming out of the compression fitting in the brass tee; once you have a good air bleed, shut off the pump and reconnect the tubing.

### 3. Pump Loses Prime Or Has Trouble 'Catching Prime' After It Has Been Shut Off

**NOTE:** This problem is limited to retrofit installations. It is caused by either a suction side air leak; a filter (multi - port) air leak; or air in the filter partially blowing back past the pump. In any case, the pump has an 'air lock'.

- \$ Install a 2 lb. or 1 lb. water line check valve just below (on the suction side) of the pump.
- \$ Repair or replace the multi port valve gasket.
- \$ To help diagnose a plumbing air leak problem, shut off our suction side valve to find if it is the problem.
- \$ Where the pump has a 'lift' more than 3' - 4', order a stronger (than 1 1/2" lb.) spring loaded check valve from UltraPure Water Quality Inc. A 3 lb. - 6 lb. spring loaded check valve may be required.

### 4. The 'Bubble - Mist' Stops Coming Back Into The Pool

**NOTE:** Our suction side installation method requires a portion of the pumps' power. Anything affecting the pump's performance affects our air - draw.

- \$ Under normal running conditions, back washing / cleaning the filter restores the bubble-mist.
- \$ Contact your dealer to reset the Air Flow Control Insert™. It may have been plugged.
- \$ Enlarge eye - ball returns, their total cross sectional area (  $r^2$  ) should equal the cross sectional area of the pump outlet.
- \$ Replacing a worn out pump may be required.

## B. Potential Unit or Water Problems

### 1. Lamps Are Off

#### **WEAR EYE PROTECTION WHEN REPAIRING A UNIT OR REPLACING UV LAMPS UV RAYS CAN TEMPERAILY 'BLURR' YOUR VISION**

**NOTE:** The 1/4" MPT x 3/8" Kynar 'glow' tubing compression elbow lights up blue/green when your unit is working. Once you are sure there is power to the unit (i.e. pump running) contact a pool dealer or Service Company to repair the unit. Your *UltraPure™ Automatic Water Cleaner™* is designed with field serviceability in mind. Troubleshooting and repair is made very easy as there are only two (2) internal components which might need to be replaced - the lamp(s) or the ballast/transformer(s).

\$ An aluminium plate is located inside your *UltraPure™ Automatic Water Cleaner™*. To access internal components, remove the screws on the wire/cord end plate and loosen the screws on the other end plate. Then slide out the center plate.

\$ On one side of the center plate, the UV bulb(s) are mounted in stainless steel lamp holders. Remove burnt out lamp(s) and pop in the new one(s). On the other side of the center plate, are the transformer(s) or ballast and electrics. When replacement is necessary, simply remove the screws/bolts and replace the transformer(s) or ballast. Wire nut connectors must be removed and then replaced to change the lamp(s) or ballast/transformer(s).

### 2. There Is A Build Up Of Combined Chlorine (Or Bromine)

**NOTES:** The *Automatic Water Cleaner's* primary job is to remove the compounds that form combined chlorine compounds. If combines (Total Chlorine - Free Available Chlorine) rise above 0.5 ppm, there is a problem.

\$ Ensure your *UltraPure™ Automatic Water Cleaner™* is functioning properly by checking that the lamps are on when the pump is running; that there is an air draw through the unit; and that there is a fine 'bubble mist' entering the pool.

\$ Temporarily, increase the run time of the unit until the water conditions improve.

\$ Shock or super chlorinate the pool.

If we, at UltraPure Water Quality Inc., can be of further assistance to you, call us at 1 877 281 7603 - fax 905 336 1483 or e-mail [help@waterquality.net](mailto:help@waterquality.net)

# Is the Unit Working?

- ❖ Use chlorine and The *UltraPure™ Automatic Water Cleaner™* for best results.
- ❖ Use a DPD test kit or test strips to test for Free Available and Total Chlorine.
- ❖ If the difference between Total Chlorine and Free Available Chlorine is 0.5 ppm or less, The ***UltraPure™ Automatic Water Cleaner™***, is doing its job, i.e. removing contaminants that form combined chlorine compounds (Chloramines) and use up chlorine. THE UNIT IS AN AUTOMATIC TURBO INJECTED SHOCK TREATMENT to remove or alter (non living) bather wastes.

Warranty should be claimed through your dealer. If warranty cannot be handled through your dealer, please obtain a Return Goods Authorization (RGA) number, which allows you to send your unit to a local warranty repair station. Call 1 877 281 7603. Replacement or spare parts must be purchased through your dealer.

## **IMPORTANT SAFETY INSTRUCTIONS**

**UV LIGHT IS HARMFUL TO EYES AND EXPOSED SKIN; TURN OFF ELECTRICAL SUPPLY BEFORE OPENING UNIT.**

Ozone is considered to be toxic above certain concentrations and exposure times in air. If the ozone concentration in the water exceeds the equilibrium state the excess ozone will be emitted into the air. The Occupational Safety and Health Administration has set a short term exposure limit of 0.3 ppm (0.6 mg/m<sup>3</sup>) and 0.2 ppm (0.2 mg/m<sup>3</sup>) time weighted average, over an 8-hour day, five days per week. There are ozone removal methods that may be considered prior to the addition of the chemical disinfectant:

- I. Degassing by means of aerated flow;
- II. Granular activated carbon filter.

When the equipment is located in an enclosed room consideration should be given to having adequate exhaust in case of ozone releases. The exhaust system should provide a minimum of three air changes per hour to comply with OSHA limits. In addition, an ambient air ozone monitor should be installed.

Ozone systems, which operate under vacuum, should not present the danger of ozone leaks into the treatment room.

### **Important Safety Instructions**

1. **READ AND FOLLOW ALL INSTRUCTIONS.**
2. Connect to a grounded, grounding type receptacle only.
3. Do not bury cord.
4. **WARNING – To reduce risk of electrical shock, replace damaged cord immediately.**
5. Install at least 5 ft. from inside wall of the pool using nonmetallic plumbing. Install ozone generator no less than 1 ft. above the maximum water level to prevent water from contacting electrical equipment. Install in accordance with the installation instructions.
6. **WARNING – Short-term inhalation of high concentrations of ozone and long-term inhalation of low concentrations of ozone can cause serious harmful physiological effects.**  
  
Do not inhale ozone gas produced by this device.
7. **SAVE THESE INSTRUCTIONS.**

## Warranty Registration Form

To activate your warranty, please take a moment to fill out and return this form. It must be returned to UltraPure Water Quality (UWQ) Inc. within 30 days of purchase. No warranty will be registered without this card.

Date Purchased			Purchased From			
Month	Day	Year				
Model			Volt/Hz		Serial Number (blacked out numbers on label)	
UPP9 <input type="checkbox"/>	UPP15 <input type="checkbox"/>	UPP25 <input type="checkbox"/>	UPP50 <input type="checkbox"/>	120/60 <input type="checkbox"/>	240/60 <input type="checkbox"/>	
First Name			Initial	Last Name		
Address					Suite Number	
City			State/Province		Zip/Postal Code	
Area Code & Phone Number		Area Code & Fax Number		E-Mail Address		

### Terms and Conditions of Warranty

- To validate this warranty, the 'Registration of Purchase' form should be completed and mailed within 30 days of installation.
- We warrant that the Pool UltraPure™ Automatic Water Cleaner™ and all components are free from defects in material and workmanship for a period of 2 Years from the date of delivery to the first owner. This warranty is not transferable.
- To make a warranty claim you must:
  - Call 877 281-7603 and obtain an RGA (Return Goods Authorization) number. No claim will be accepted without an RGA number.
  - i) UltraPure Water Quality Inc. will send out a local area authorized warranty/field service representative (in applicable areas).

**OR**

  - If no authorized warranty/field service representative is in the area the manufactured goods, in need of service, should be shipped (with RGA) to the address on the RGA form, **freight, pre-paid**. Any returned item deemed faulty due to manufacturer defect will be repaired or replaced and shipped back to the customer at no charge to the customer.
  - The owner of the UWQ goods may be responsible for all expenses** if the field serviced (i) or returned item (ii) is deemed operational, or not under warranty. Non-warranty goods will be shipped back to the customer at **customer's expense**.
- This warranty supercedes any previously printed or issued warranty.
- Warranty will be void if manufacturers installation instructions are not followed.
- Warranty will be void unless our factory-approved parts are used and properly installed by an authorized representative according to UWQ recommendations contained in the instruction manual attached.
- Warranty does not extend to parts misused, mishandling, neglect, accident, damage, flood, fire or other causes beyond the control of the manufacturer. The warranty does not extend to consequential damage

**Please Mail Original and Retain a Copy for Your Records**

UltraPure Water Quality Inc., 1175 Appleby Line, Unit B2, Burlington, Ontario – L7L 5H9

Phone: 905 335-4085 Fax: 905 335-1483 Customer Service: 877 281-7603