



## DESIGN & CONSTRUCTION GUIDELINES

**CrystalStones™** is an extremely durable and versatile product.

The information and sketches on the following pages discuss construction techniques which will allow this product to be used to its full potential, while minimizing problems and ensuring the best possible application.

Please take a few moments to review this material and call us if you have any questions.

**C.L. INDUSTRIES, INC.**

P.O. Box 593704 • 8188 S. Orange Ave. • Orlando, Florida 32859-3704  
**407- 851- 2660 • 1- 800- 333- 2660**

C.L. INDUSTRIES, INC.

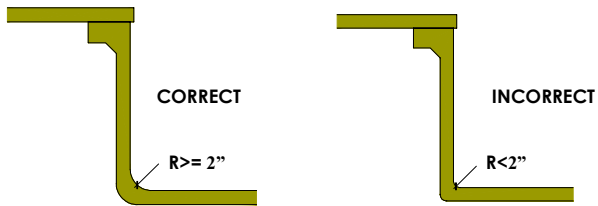

ALL CORNERS AND EDGES OF STEPS, PARTICULARLY **OUTSIDE**, SHOULD HAVE A RADIUS ( $\geq 2"$ ) TO ALLOW FOR A SMOOTH ROLLED EDGE.

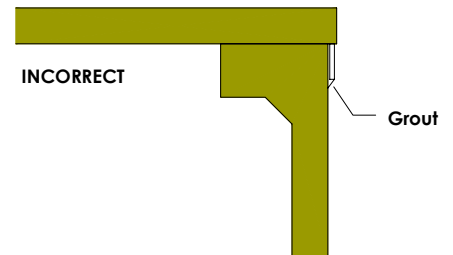
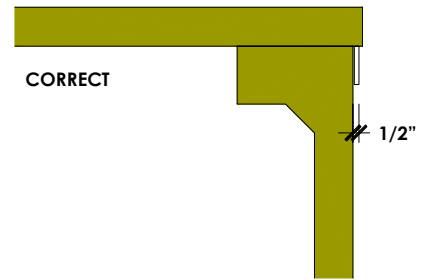

#### STEPS & BENCHES

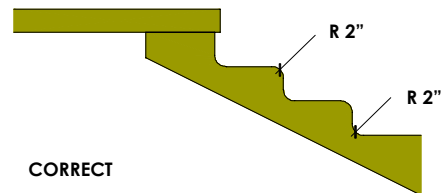
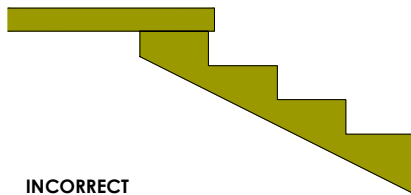

#### POOL FLOOR AREAS

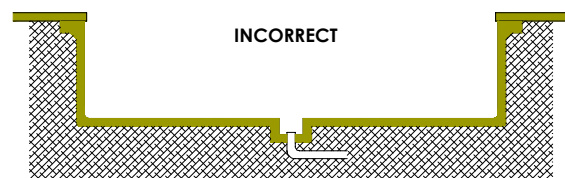
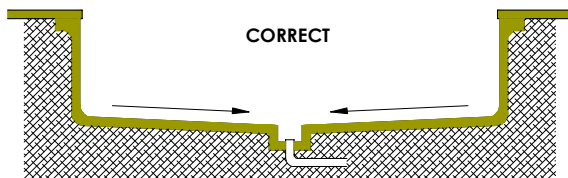

ALL FLAT SURFACES SHOULD HAVE SLOPE TOWARDS THE DEEPEST POINT IN THE POOL. (MINIMUM  $1/2"$  PER FOOT). THE LOWEST POINT IN THE POOL (TYPICALLY THE MAIN DRAIN) SHOULD HAVE AN AREA DISHED OUT AT LEAST  $12" \times 12" \times 2"$ .

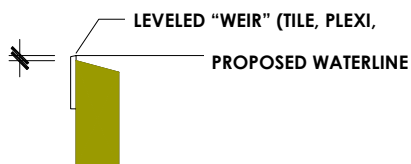

NAIL "MASONITE" OR SIMILAR MATERIAL TO FACE OF THE BEAM (APPROX. ½" THICKNESS) AND WATER LEVEL TO THE HIGHEST POINT OF THE BOND BEAM. FLOAT BEAM LEVEL USING A BONDING AGENT. ALLOW FLOATED BEAM TO DRY. AT TIME OF DECK POUR, PLACE SAND ON BEAM.

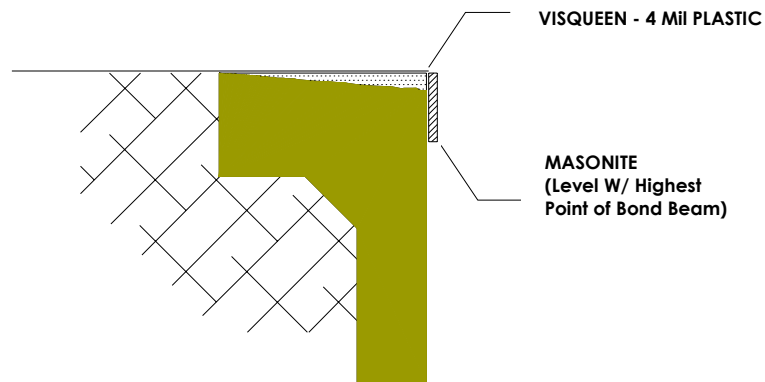

CANTILEVER MASONITE OR STYROFOAM FORMS SHOULD THEN BE ATTACHED TO THE MASONITE.

**MASONITE FORMS**

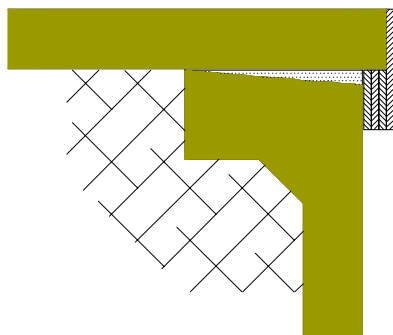

**STYROFOAM FORMS**

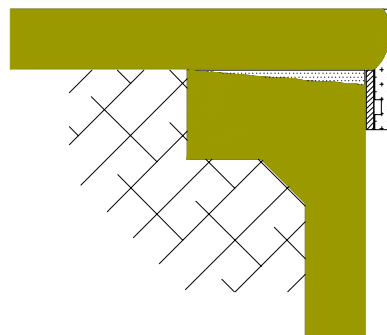

PRIOR TO CRYSTALSTONES™ THE MASONITE SHOULD BE REMOVED (WITH WATER STOP IN PLACE IF APPLICABLE) AND CRYSTALSTONES™ CAN BE APPLIED.

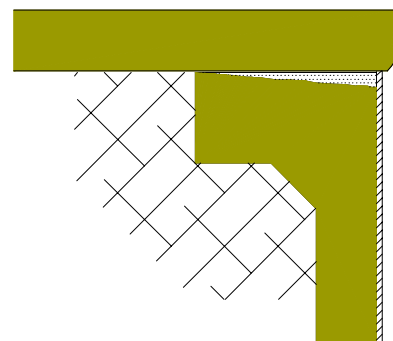
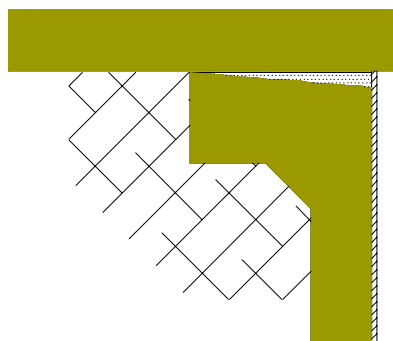

---

## ADDITIONAL CONSTRUCTION/DESIGN CONSIDERATIONS

---

- Shells should be cured a minimum of 28 days, broom finished and wet down for several days prior to application of CrystalStones™.
- Any items protruding through the shell should have cut outs for proper sealing.
- Sealers should never be used at waterline.
- There is a capillary action created when CrystalStones is used without tile at the waterline and with attached spas utilizing a spillway. Whenever water comes in contact with dry CrystalStones, moisture creating a wet look is transferred approximately 1 - 2". The outer edge of this moisture is subject to mineral buildup.
- Excess cement must be handled properly.
- Rolled bond beams should be limited to 18" and should slope away from the pool to allow for runoff during the exposure process.
- We recommend that you "balance" your pool water utilizing the "saturation" index. This system takes into account....PH, alkalinity, water temperature, chlorine and calcium harness.
- Consideration should be given to an expansion joint at beach entry where it meets the deck.

